

ECROU METRIQUE

MLS

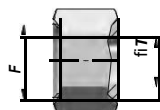

Code Article	TYPE	ØT	F	kg x 100
FB 6ML12 X 1.5	6 L	6	M12x1,5	0,90
FB 8ML14 X 1.5	8 L	8	M14x1,5	1,20
FB10ML16 X 1.5	10 L	10	M16x1,5	2,10
FB12ML18 X 1.5	12 L	12	M18x1,5	2,40
FB15ML22 X 1.5	15 L	15	M22x1,5	3,90
FB18ML26 X 1.5	18 L	18	M26x1,5	5,90
FB 22ML30 X 200	22 L	22	M30x2	7,90
FB28ML36 X 200	28 L	28	M36x2	8,40
FB 6MS14 X 1.5	6 S	6	M14x1,5	1,40
FB 8MS16 X 1.5	8 S	8	M16x1,5	1,60
FB 10MS18 X 1.5	10 S	10	M18x1,5	3,10
FB 12MS20 X 1.5	12 S	12	M20x1,5	3,60
FB 14MS22 X 1.5	14 S	14	M22x1,5	5,10
FB 16MS24 X 1.5	16 S	16	M24x1,5	6,10
FB 20MS30 X 2	20 S	20	M30x2	9,40
FB 25MS36 X 2	25 S	25	M36x2	19,50

BAGUE DE SERRAGE

ACL

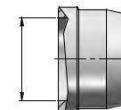

Code Article	Type	ØT	kg x 100
FBACL06	06 LS	6	0,13
FBACL08	08 LS	8	0,19
FBACL10	10 LS	10	0,24
FBACL12	12 LS	12	0,31
FBACL15	15 L	15	0,41
FBACL18	18 L	18	0,46
FBACL22	22 L	22	0,60
FBACL28	28 L	28	0,75
FBACS14	14 S	14	0,36
FBACS16	16 S	16	0,41
FBACS20	20 S	20	0,85
FBACS25	25 S	25	1,06

UNION SIMPLE MALE

AKL

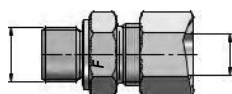

Code Article	TYPE	ØT	F BSP	kg x 100
FB09206DL6	6 L	6	1/8"	2,50
FB09208DL8	8 L	8	1/4"	4,50
FB09210DL10	10 L	10	1/4"	4,70
FB09212DL12	12 L	12	3/8"	6,50
FB09215DL15	15 L	15	1/2"	11,50
FB09218DL18	18 L	18	1/2"	13,00
FB09222DL22	22 L	22	3/4"	18,00
FB09228DL28	28 L	28	1"	25,00
FB09206DS6	6 S	6	1/4"	5,20
FB09208DS8	8 S	8	1/4"	6,00
FB09210DS10	10 S	10	3/8"	9,00
FB09212DS12	12 S	12	3/8"	10,20
FB09214DS14	14 S	14	1/2"	15,20
FB09216DS16	16 S	16	1/2"	16,00
FB09220DS20	20 S	20	3/4"	27,00

UNION SIMPLE MALE

AL

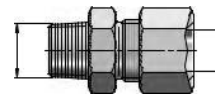

Code Article	TYPE	ØT	F BSPT	kg x 100
FB09306DL6	6 L	6	1/8"	2,40
FB09308DL8	8 L	8	1/4"	4,20
FB09310DL10	10 L	10	1/4"	4,70
FB09312DL12	12 L	12	3/8"	6,50
FB09315DL15	15 L	15	1/2"	10,80
FB09318DL18	18 L	18	1/2"	14,30
FB09322DL22	22 L	22	3/4"	19,50
FB09328DL28	28 L	28	1"	30,00
FB09306DS6	6 S	6	1/4"	5,40
FB09308DS8	8 S	8	1/4"	6,00
FB09310DS10	10 S	10	3/8"	8,00
FB09312DS12	12 S	12	3/8"	9,90
FB09314DS14	14 S	14	1/2"	14,40
FB09316DS16	16 S	16	1/2"	16,50
FB09320DS20	20 S	20	3/4"	26,00
FB09325DS25	25 S	25	1"	49,50